

PRESSURE REGULATOR

HIGH PRESSURE



A two chamber, diaphragm type fuel pressure regulator. The fuel chamber is separated from the spring chamber by a fabric reinforced, fluoro rubber diaphragm, which is pre-loaded by a compression spring. The spring housing is vented to atmosphere. Connection to the fuel rail is by partitions in the fuel chamber. The regulator is intended for applications requiring pressures in excess of 16barg. For example, to exploit the high pressure capabilities of the TSR2.1 motorsport fuel injector which operates at up to 30barg.

Please request our installation datasheet for further details.

Electrical

- Reflow characteristic, rated and maximum pressures are shown in the order details
- Full reflow >400l/hr
- Rated pressure is calibrated at reflow set point
- Rated pressure accuracy ± 25 mbar at reflow set point
- Reflow characteristic is the pressure increase due to each 100l/hr reflow above set point
- Sealing pressure (minimum pressure held 5 min after supply has stopped) 4barg
- Regulation accuracy ± 80 mbar on reflow testing

Application

- Fuel pressure control for injector systems

Mechanical

- Body aluminium alloy, hard anodised, dyed black
- Weight is shown in the order details

Design and manufacture is in-house, so if our existing designs do not suit your application, we can provide cost effective customised parts to suit even the most demanding application.

Please contact our technical consultancy service who will be pleased to help.

Environmental

- Resistant to standard motorsport fluids
- Operating temperature 0 to +125°C

PRESSURE REGULATOR

HIGH PRESSURE

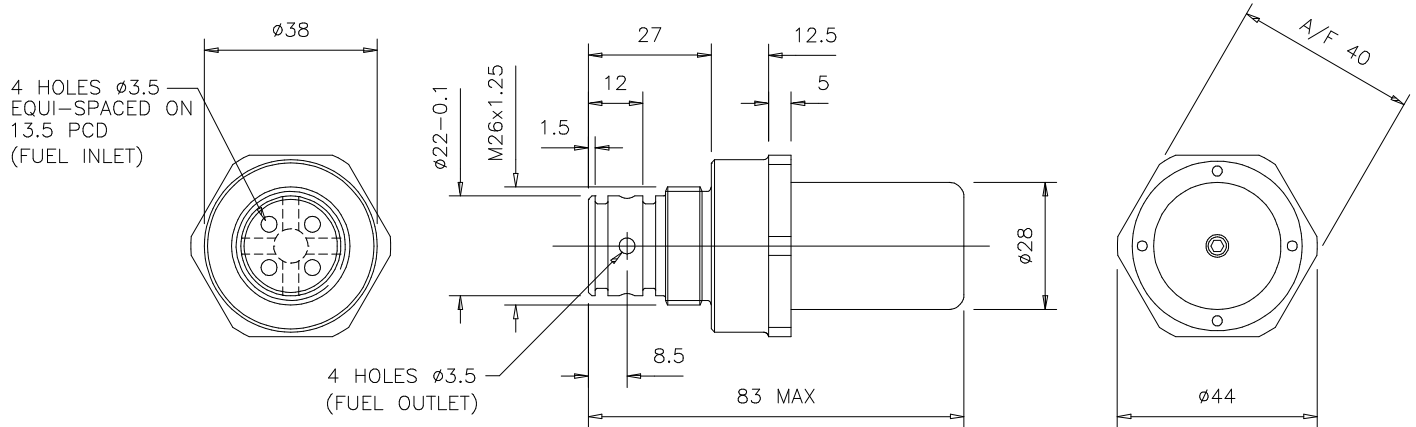

Rated Pressure	Max Pressure	Reflow Characteristic	Reflow Set Point	Weight	Order Code
16barg	20barg	< 70mbar/(100l/h)	110l/hr	165g	O 030 510 300 001
30barg	34barg	< 180mbar/(100l/h)	110l/hr	165g	O 030 510 300 000
Accessories		Set of 2 O rings			O 030 510 990 003

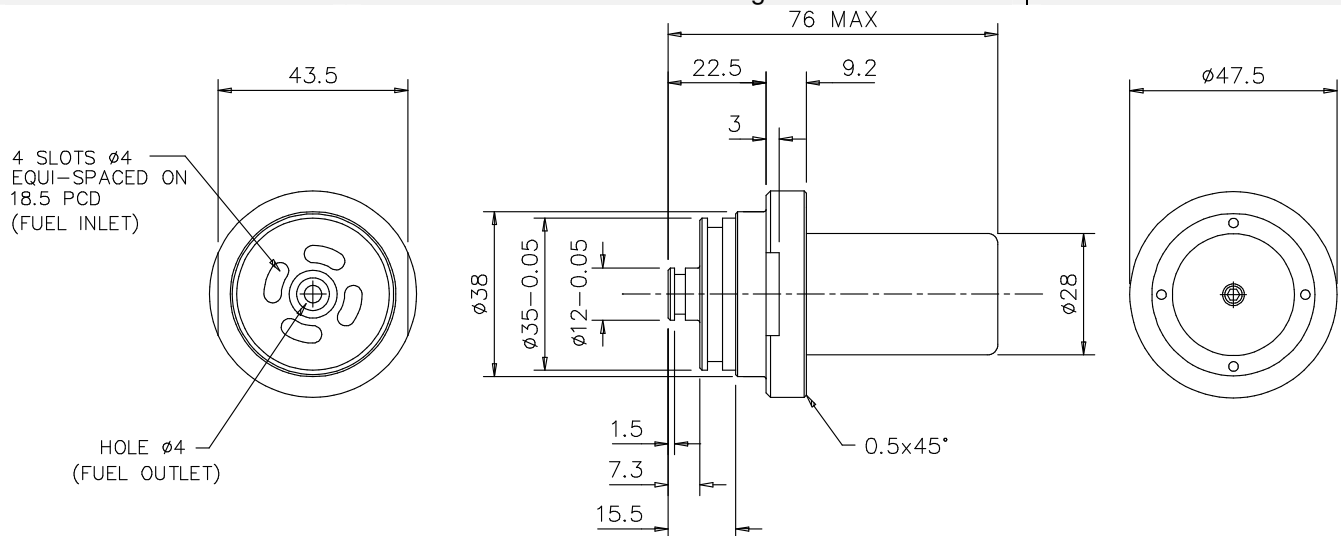

Rated Pressure	Max Pressure	Reflow Characteristic	Reflow Set Point	Weight	Order Code
22barg	34barg	< 180mbar/(100l/h)	150l/hr	175g	O 030 510 300 002
30barg	34barg	< 180mbar/(100l/h)	150l/hr	175g	O 030 510 300 003
Accessories		Set of 2 O rings			O 030 510 990 005